

DETAIL & SUBMITTAL SHEET



SPECIFICATIONS:

- Door:** 18 ga. steel
- Frame:** 16 ga. steel, 2 1/2" deep
- Insulation:** 2" thick mineral wool (THERMAFIBER®), in between two pieces of 22 ga. steel
- Hinge:** Fully concealed, pivot rod type hinge. Allows opening to 140°
- Latches:** Specially designed Ultra Lock—self-latching keyed cylinder paddle latch (WB 151 key code) Can be replaced in the field if damaged
- Automatic Panel Closer:** Furnished on all doors. vertical position only. Ceiling position requires self-assisted closing
- Inside Panel Release:** Furnished on all doors
- Finish:** Grey baked enamel coat
- Ceiling Installation:** To comply with current fire regulations, largest size acceptable is 24" x 36"

OPTIONS:

- Finishes:**
- Stainless Steel Type 304 No. 4 Satin Finish Brushed
 - Stainless Steel Type 316 No. 4 Satin Finish Brushed
- Options:**
- Mortise Best Lock
 - Hot Smoke Seal gasketing all 4 sides**
 - Special sizes available

FRONT ELEVATION

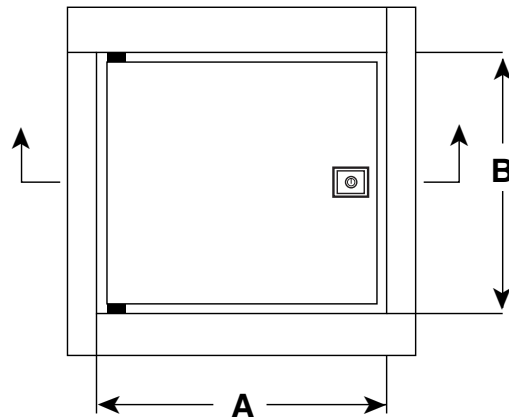

SECTION DETAIL

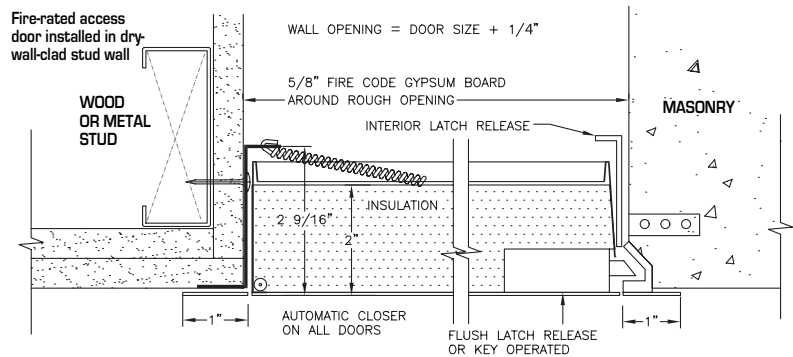

Fire-rated access door installed in three-hour ceiling system

On size 16" x 16" and larger, extra spring supplied with door must be attached from back of door pan to framing or floor above in such a manner to insure that door is self-closing

✓	Item No.	Door Size W x H	Wall Opening	Slam Catch	Ship Wt. Lbs.
	FRU 810	8 x 8	8 1/4 x 8 1/4	1	8
	FRU 810	10 x 10	10 1/4 x 10 1/4	1	10
	FRU 810	12 x 12	12 1/4 x 12 1/4	1	12
	FRU 810	12 x 18	12 1/4 x 18 1/4	1	16
	FRU 810	12 x 24	12 1/4 x 24 1/4	1	19
	FRU 810	14 x 14	14 1/4 x 14 1/4	1	14
	FRU 810	16 x 16	16 1/4 x 16 1/4	1	17
	FRU 810	18 x 18	18 1/4 x 18 1/4	1	21
	FRU 810	18 x 24	18 1/4 x 24 1/4	1	26
	FRU 810	20 x 20	20 1/4 x 20 1/4	1	24
	FRU 810	20 x 24	20 1/4 x 24 1/4	2	30
	FRU 810	20 x 30	20 1/4 x 30 1/4	2	37
	FRU 810	21 x 36	21 1/4 x 36 1/4	2	43
	FRU 810	22 x 22	22 1/4 x 22 1/4	1	28
	FRU 810	22 x 24	22 1/4 x 24 1/4	1	29
	FRU 810	22 x 30	22 1/4 x 30 1/4	2	39
	FRU 810	22 x 36	22 1/4 x 36 1/4	2	47
	FRU 810	24 x 24	24 1/4 x 24 1/4	1	32
	FRU 810	24 x 30	24 1/4 x 30 1/4	2	43
	FRU 810	24 x 36	24 1/4 x 36 1/4	2	48
	FRU 810	24 x 48	24 1/4 x 48 1/4	2	62
	FRU 810	30 x 30	30 1/4 x 30 1/4	2	50
	FRU 810	32 x 32	32 1/4 x 32 1/4	2	55
	FRU 810	36 x 36	36 1/4 x 36 1/4	2	67
	FRU 810	36 x 48	36 1/4 x 48 1/4	2	88
	FRU 810	48 x 48	48 1/4 x 48 1/4	2	104

This door has the same construction features as the WB-FR Standard door featuring our specially designed Ultra Lock with 151 key assembly—self-latching keyed cylinder paddle latch. This door is approved for wall and ceiling use.

** Hot Smoke Seal™ fire tested: Listed to meet the requirements of standards UL10B, UL10C, UBC 7-2, Part 1 and BS476: 1987 for application to fire rated door assemblies.

Thermafiber THERMAFIBER® Industrial Felt insulation for optimal fire protection (rated noncombustible by NFPA Standard 220 when tested in accordance with ASTM E136 and withstands ASTM E119) and superior sound control USG tested per ASTM C165: 8 pcf STC 15-2" thickness

UL UL, Northbrook, IL - 1-1/2 hour "B" label 450 degrees F (250 degrees C) maximum temperature rise in 30 minutes for vertical wall installations only. Test file number R-10364. This door may be used in a two hour fire rated wall assembly

Warnock Hersey LISTED Warnock Hersey International; Pittsburgh, CA - 1 hour fire rated combustible floor and ceiling assembly Report # WHI-495-PSH-0191

Warnock Hersey International; Pittsburgh, CA - 3 hour fire rated non-combustible floor and ceiling assembly - Report # WHI-495-PSH-0192

Project: _____ Date: _____

Contractor: _____ Architect: _____

Sizes: _____ Quantity: _____ Approval Initials: _____



Corporate Office: 1330 Progress Drive • Front Royal, VA 22630
Phone: 1-800-255-5515 • Fax: 1-800-822-5001

www.wbdoors.com